

1. Contraction Joint (also called saw cuts/control joints)

The term "Contraction Joint" is taken from ACI 302 document to maintain consistent nomenclature with the concrete and engineering industry.

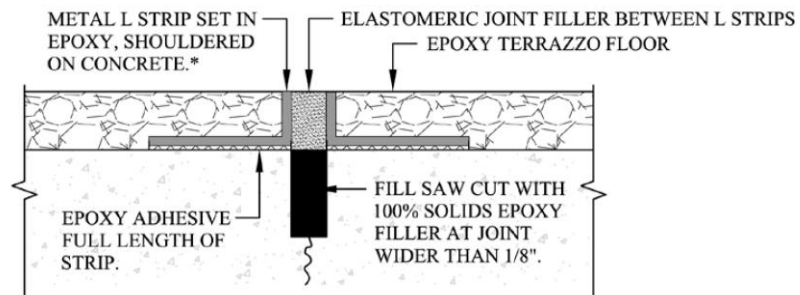

Scale: Full Scale

Option: For "art work areas". See buried contraction joint. Refer to detail 3

*Care should be taken by concrete contractor to provide a straight joint, placed in coordination with design teams consideration of final grid pattern. Square edges encouraged, tooled edges discouraged.

**This detail must be used for radiant heated floors.