

GUIDE SPECIFICATION FOR VERTICAL TERRAZZO

(Revised 6/94 Supersedes all previous Specifications for Vertical Terrazzo)

SECTION 09

VERTICAL TERRAZZO

Normally 1 inch thick (3/8" terrazzo topping).
(See architectural details)

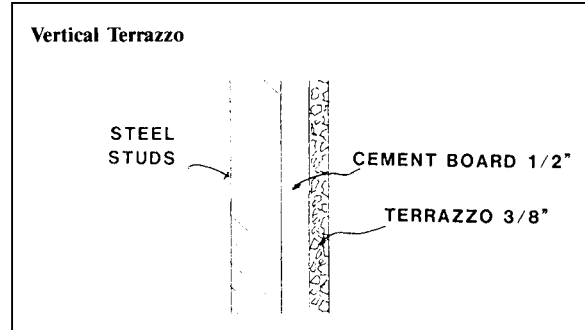

PART 1-GENERAL

1.01 RELATED WORK SPECIFIED IN OTHER SECTIONS

NOTE: DELETE NONAPPLICABLE ITEMS.

- A. Furnishing and/or installation of metal lath and scratch coat, Backing for terrazzo must be a cement board, concrete or concrete block.

Section _____

- B. Attachment of metal base beads and wood ground,

Section _____

NOTE: DELETE IN CASES WHERE JURISDICTION PERMITS TERRAZZO CONTRACTOR TO INSTALL.

- C. Sufficient water, temporary heat and light, and adequate electric with suitable outlets connected and distributed for use within 100 feet of any working space.

NOTE: AMBIENT TEMPERATURES SHALL BE MAINTAINED AT A MINIMUM OF 50 DEGREES FAHRENHEIT.

1.02 QUALITY ASSURANCE

- A. Acceptable supplier:
1. Materials furnished shall meet NTMA Specifications.
- B. Installer qualifications:
1. Installer shall be a contractor member of NTMA and shall perform all work in accordance with NTMA standards.
2. If installer is not a contractor member of NTMA, they shall submit a list of completed projects of a similar magnitude and complexity.

1.03 SUBMITTAL

- A. Samples:
1. Submit a maximum of three samples, minimum 6" x 6" for each color and type of terrazzo.
2. Submit two, 6" minimum lengths of each type and kind of divider strips.
- B. Maintenance Literature:
1. Submit two copies of maintenance recommendations of NTMA or maintenance product members of NTMA.
- C. Certification:
1. Suppliers shall furnish certification attesting that materials meet specification requirements.

1.04 DELIVERY, STORAGE AND HANDLING

- A. Delivery of materials:
1. Deliver materials in a manner to prevent damage to containers and/or bags.
- B. Storage of materials:
1. Store materials in a clean, dry and heated (if necessary) location.

1.05 GUARANTEE

One year from date of substantial completion of Terrazzo installation.

PART 2-PRODUCTS

2.01 MATERIALS

- A. Portland cement: ASTM C 150, Color _____
NOTE: SELECT AND SPECIFY WHITE OR GRAY FOR TERRAZZO TOPPING. WHITE CEMENT IS UNIFORM IN COLOR. GRAY CEMENT MAY NOT BE UNIFORM IN COLOR AND MAY PRODUCE A VARIATION OF SHADE IN THE MATRIX. (See product information)
- B. Sand: Clean, washed, locally available sand.
- C. Marble Chips:
1. Size to conform with NTMA gradation standards.
NOTE: SEE PRODUCT INFORMATION.
2. Abrasion and Impact resistance when testing in accordance with ASTM C 131-89 shall not exceed 40% loss.
3. 24-hour absorption rate not to exceed 0.75%.
4. Chips shall contain no deleterious or foreign matter.
5. Dust Content less than 1% by weight.

- D. Strips:

1. Divider _____ (gauge)
_____ (material)
with a depth of _____ (inches)
for a topping thickness of _____ (inches).

NOTE: (See Divider Strips) Select gauge, material, and strip depth.

GAUGE: 18, 16 OR 14 B & S gauge or 1/8, 1/4, or 3/8 - inch heavy top 1 inch depth.

MATERIAL: White alloy of zinc, brass or plastic.

DEPTH OF TOPPING: 3/8 inch for standard Terrazzo. K or L strips may be used for aesthetic reasons and are anchored by nailing or adhesive directly on substrate.

- E. Colorants: Alkali-resistant color stable pigments.
NOTE: REFER TO NTMA INFORMATION GUIDE FOR FURTHER INFORMATION.
- F. Curing Material: Water, or Polyethylene Sheeting.
- G. TERRAZZO CLEANER:
 - 1. Ph factor between 7 and 10, where applicable.
 - 2. Biodegradable and phosphate free.
- H. Sealer:
 - 1. Ph factor between 7 and 10, where applicable.
 - 2. Shall not discolor or amber.
 - 3. Penetrating type specially prepared for use on Terrazzo.
 - 4. Flash Point: ASTM D 56, 80 degrees Fahrenheit minimum, where applicable.
- I. Bonding Agent: Neat Portland Cement, Epoxy or Acrylic

2.02 MIXES

- A. Terrazzo Selection:

1. Type: _____

NOTE: SELECT COLOR AND DESIGN FOR NTMA INFORMATION GUIDE OR COLOR PLATES. ANY DEVIATION FROM NTMA PLATES MUST BE CLEARLY STIPULATED.

NOTE: SINCE DIFFERENT INSTALLATION TECHNIQUES ARE REQUIRED FOR VERTICAL TERRAZZO, IT MAY BE DIFFICULT OR IMPOSSIBLE TO MATCH EXACTLY THE FLOOR OR BASE COLOR. WHERE POSSIBLE, A DIFFERENT COLOR SHOULD BE SPECIFIED.

- B. Proportions:
 - 1. Setting Bed: One part Portland cement to three parts sand and sufficient water to provide workability at as low a slump as possible.
 - 2. Terrazzo Top: One 94 pound bag of Portland Cement per 125 pounds of marble chips, color pigment if required and sufficient potable water to produce a workable mix.
- C. Mixing:
 - 1. Setting bed:
 - a. Charge and mix sand, aggregate and Portland cement.
 - b. Add water and mix.
 - 2. Terrazzo topping:
 - a. Charge and mix marble chips, Portland cement and color pigment, if required.
 - b. Add water and mix to a uniform workable consistency.

PART 3-EXECUTION

3.01 INSPECTION

- A. Examine areas to receive terrazzo for defects in existing work that work that affect proper execution of Rustic Terrazzo.
 - 1. Defects in existing work that affect proper execution of terrazzo.
- B. Start work only when all defects have been corrected by others.

3.02 INSTALLATION

- A. Setting Bed:
 - 1. Apply bonding agent.
 - 2. Apply mortar setting bed to backing.
 - 3. Trowel setting bed to within 3/8" of finished wall line
 - 4. Install divider strips as shown on drawings in semi-plastic setting bed.
NOTE: VERTICAL STRIPS SHOULD NOT EXCEED 72 INCHES ON CENTER.
- B. Placing Terrazzo:
 - 1. Wet setting bed and apply neat cement slurry same color as specified for the topping including pigment if contained in topping.
 - 2. Broom slurry into setting bed surface.
 - 3. Apply terrazzo mixture in panels formed by divider strips and trowel mixture to top of strips.
 - 4. Roll and compact surface until all excess cement and water has been extracted.
- C. Curing:
 - 1. After completing placement of terrazzo, apply curing material.
 - 2. Cure until topping develops sufficient strength to prevent lifting or pulling of marble chips during grinding.
- D. Finishing:
 - 1. Rough Grinding:
 - a. Grind with 24 or finer grit stones or with comparable diamond plates.
 - b. Follow initial grind with 80 or finer grit stones.
 - 2. Grouting:
 - a. Cleanse terrazzo with clean water and rinse.
 - b. Remove excess rinse water and hand apply grout using identical Portland cement, color pigments as used in topping, taking care to fill voids.
 - 3. Cure Grout.
NOTE: GROUT MAY BE LEFT ON TERRAZZO UNTIL ALL HEAVY AND MESSY WORK IN PROJECT IS COMPLETED.
 - 4. Fine Grinding:

- a. Grind with 80 or finer grit stones until all grout is removed from surface.
 - b. Upon completion, terrazzo shall show a minimum of 70% of marble chips.
- E. Cleaning and Sealing:
 - 1. Wash all surfaces with a neutral cleaner.
 - 2. Rinse with clean water and allow surface to dry.
 - 3. Apply sealer in accordance with manufacturer's directions.
- F. Protection:
 - 1. Upon completion, the work shall be ready for final inspection and acceptance by the owner or his agent.
 - 2. The General Contractor shall protect the finished work from the time that the terrazzo contractor completes the work.